

Harbourfront Commission Presentation

HC/01/2021

14 April 2021

KAI TAK
SPORTS PARK
啟德體育園



Background

1. Members to note the latest progress and design of the Sports Park
2. Suggestions and comments raised at the previous meeting on 15 January 2019

- Connectivity & Accessibility
- Water-Land Interface
- Vibrancy
- Greening & Sustainability
- Cycling
- Design

3. Adjacent Hotel Site Public Open Space (H/O POS Site)

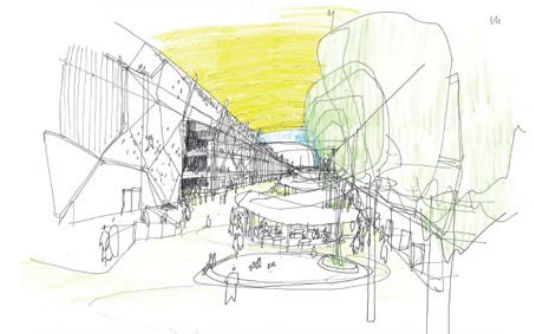
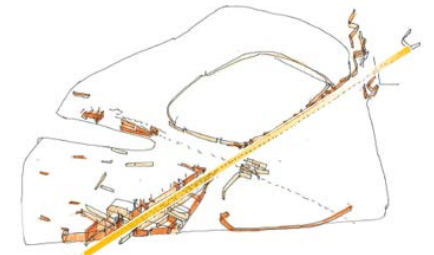
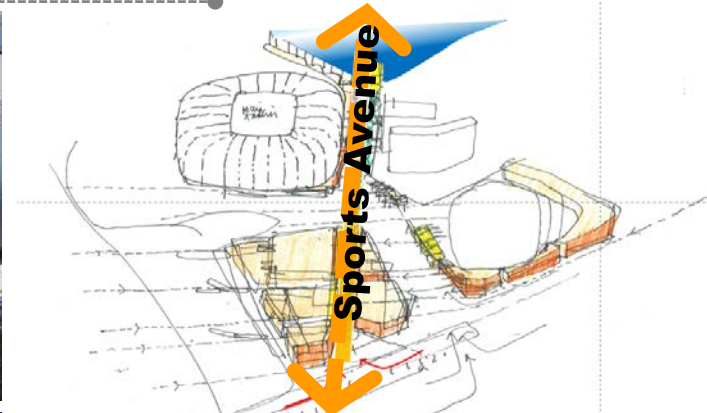

Site Location

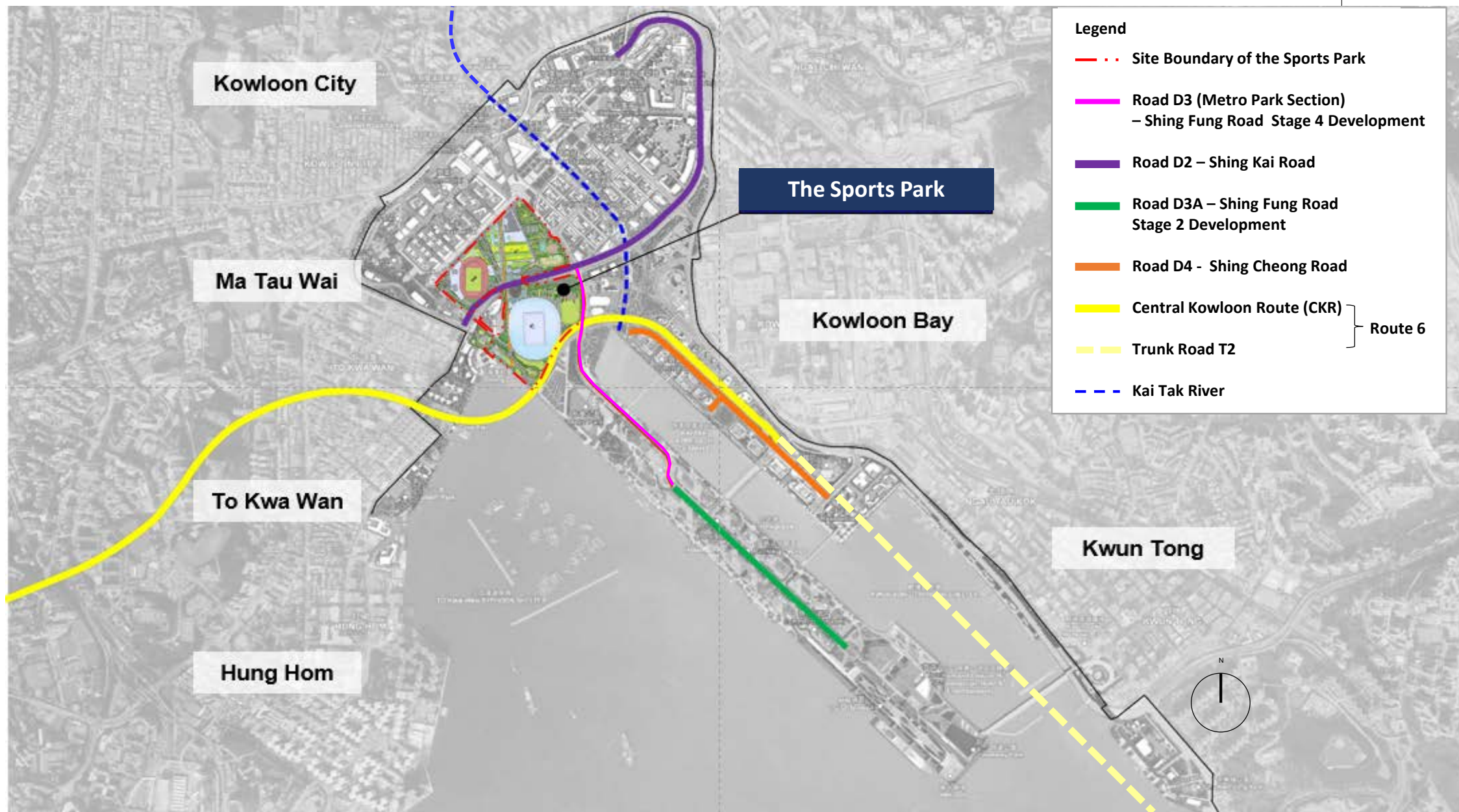

Site Location – Nearby Public Open Space and Major Circulation



Planning Objectives and Design Principles

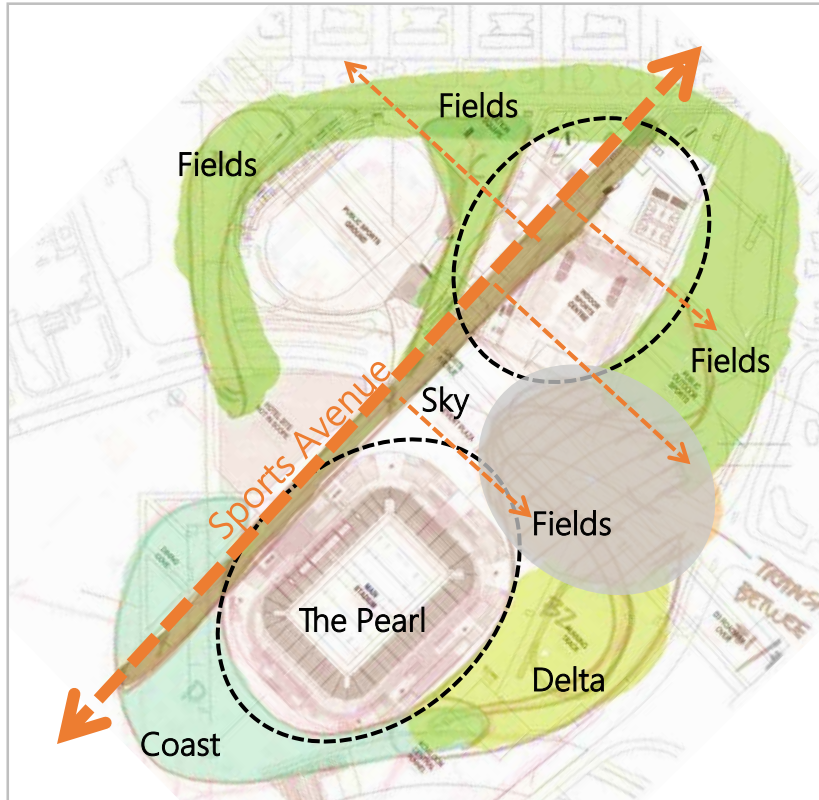

1 “Connected and Integrated” -
Strong Axis + Integrated Site Approach



2 “Smart and Sustainable” -
Smart + Healthy + Low Carbon Footprint



3 “Enjoyable and Vibrant” -
Engaging Active Spaces + Pleasant walking experience

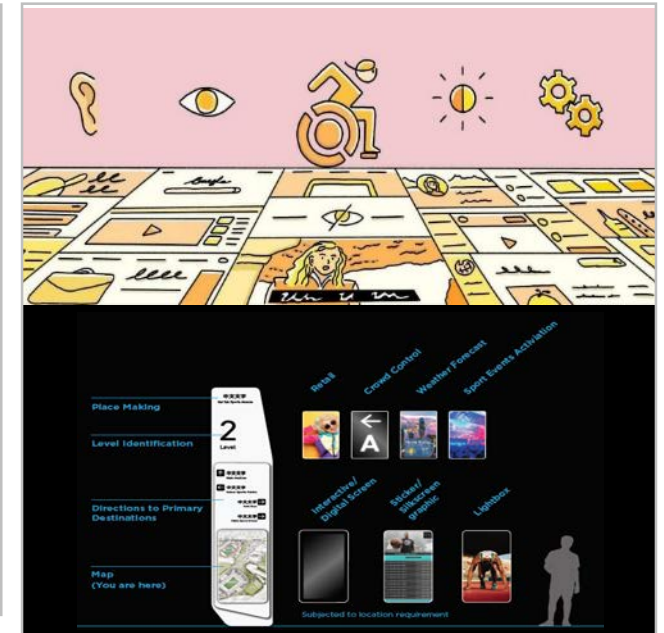

Inclusive Play Space



4 “Safe and Inclusive” -
Enhanced Wayfinding & Identity +
Inclusive Place for All

Connectivity & Accessibility - The Hinterland to Harbourfront Promenade

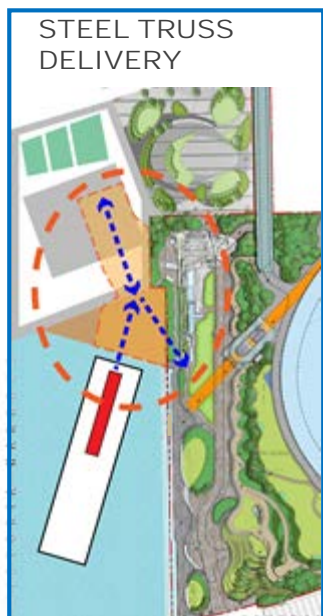

*OPENING DATE AFTER OPENING OF THE SPORTS PARK

Connectivity & Accessibility - The Sports Park and Station Square

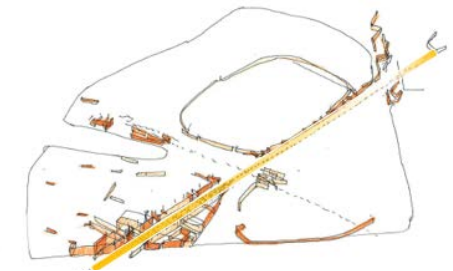
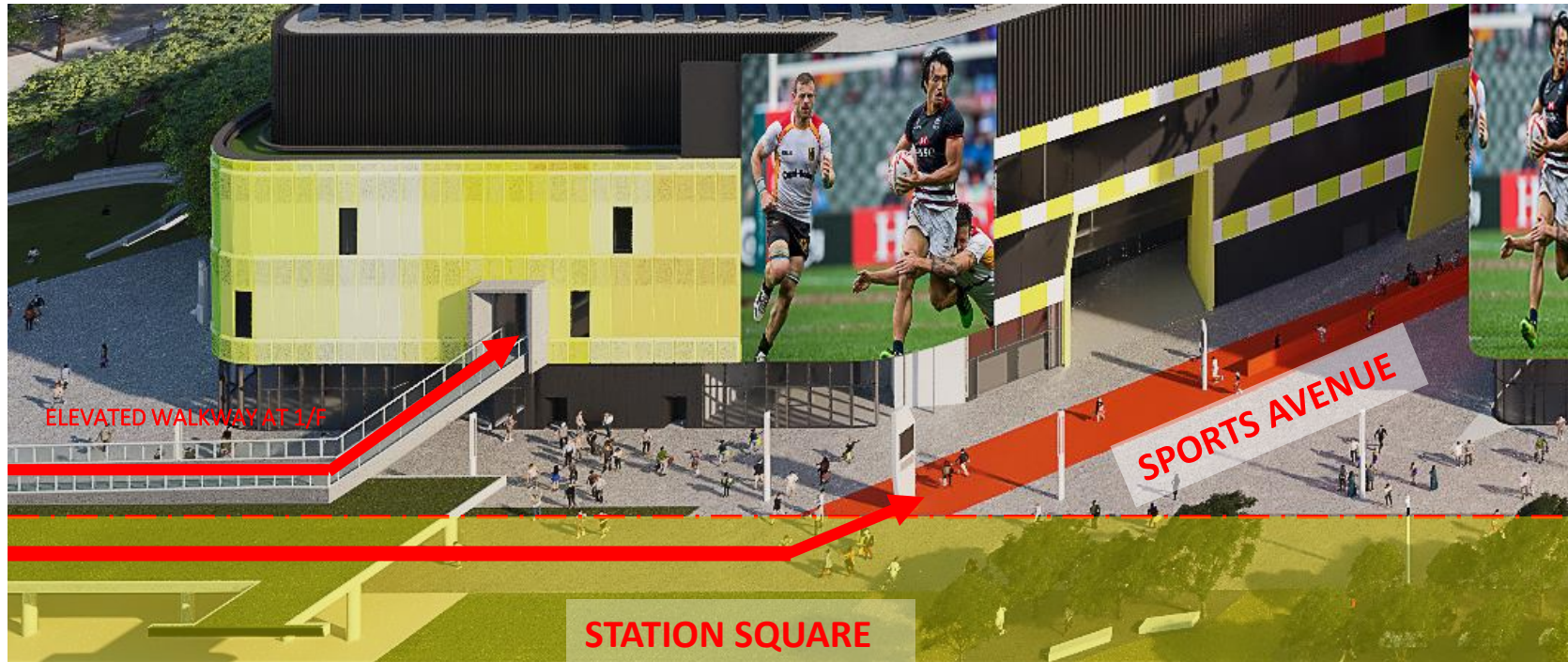
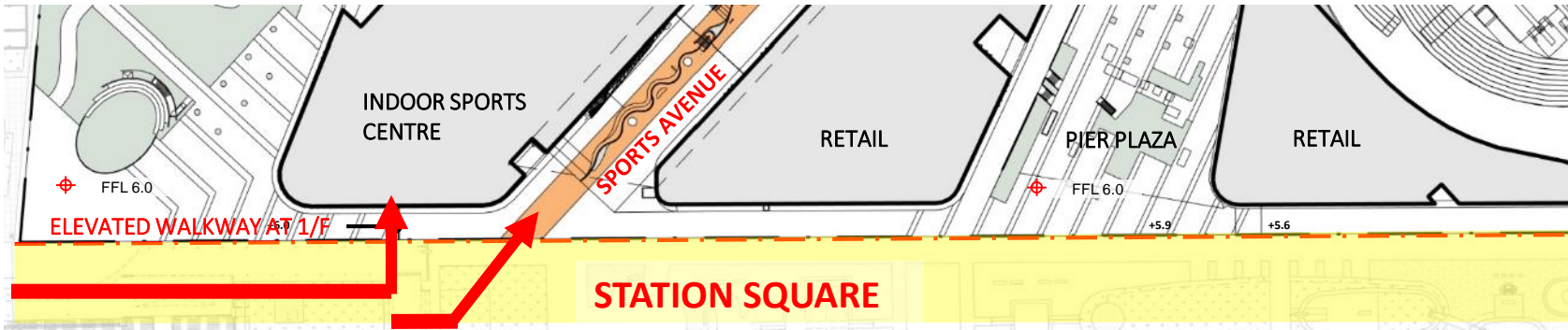

Active retail frontage



Sheltered passageway with vibrancy

Legend

- Site Boundary of the Sports Park
- ↔ Elevated walkway at 1/F (from Station Square to the Sports Park)

Connectivity & Accessibility - The Sports Park to Kai Tak Basecamp

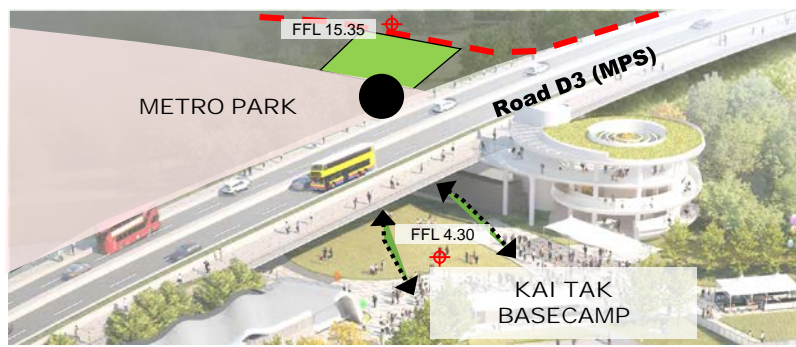
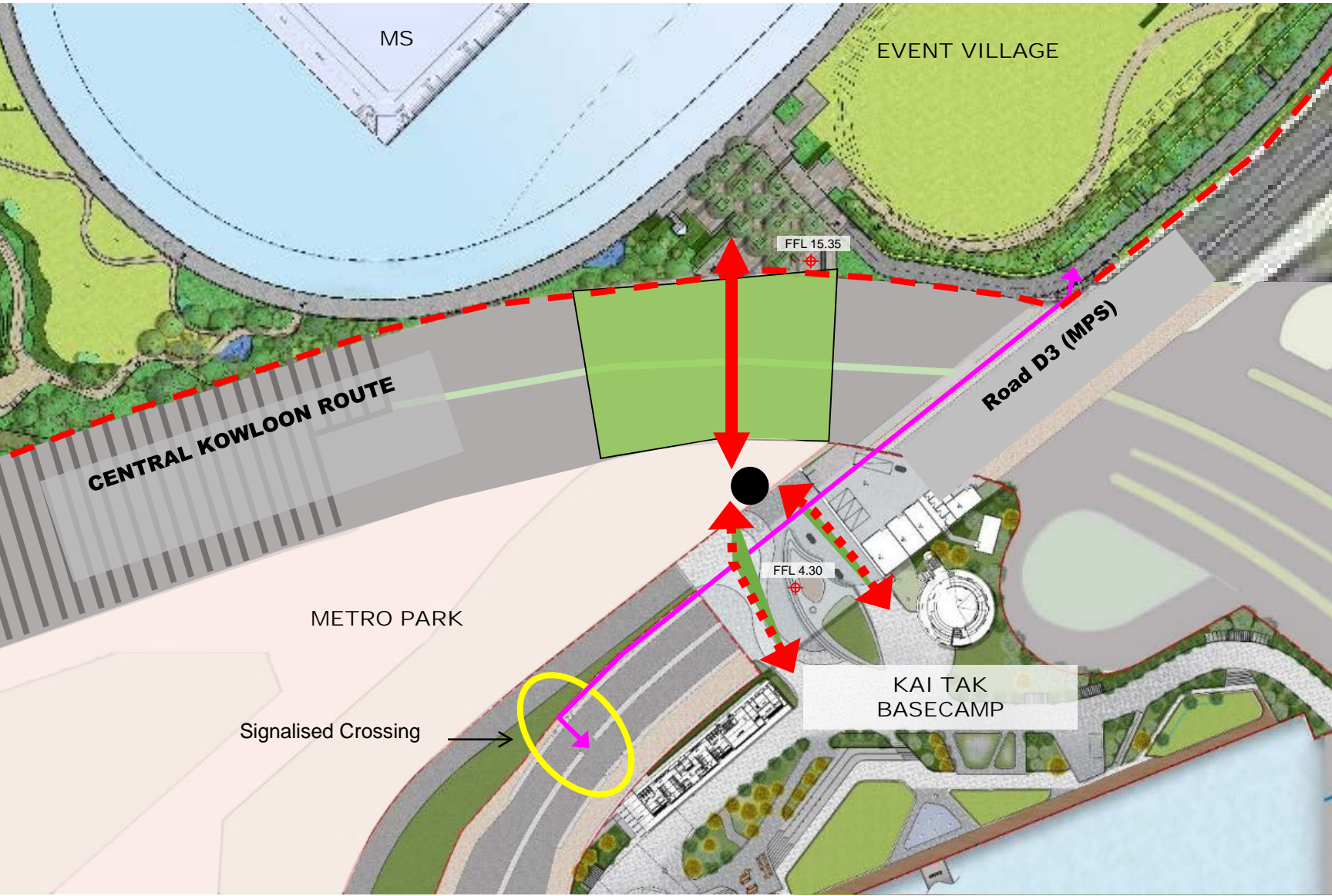

- Legend
- Site Boundary of the Sports Park
 - ↔ Interim Pedestrian Route before Completion of Metro Park (on road level)
 - Future Permanent Pedestrian Route after Completion of Metro Park (ground level walkway)
 - ↔ Future Permanent Pedestrian Route after Completion of Metro Park
 - Future Landscaped Deck of Metro Park above Central Kowloon Route
 - Future Vertical Connection to be provided by Metro Park (from level +15.35 to level +4.30)
- Extent and location are subject to design

Connectivity & Accessibility

- The Sports Park to Hotel Public Open Space and Hotel Site

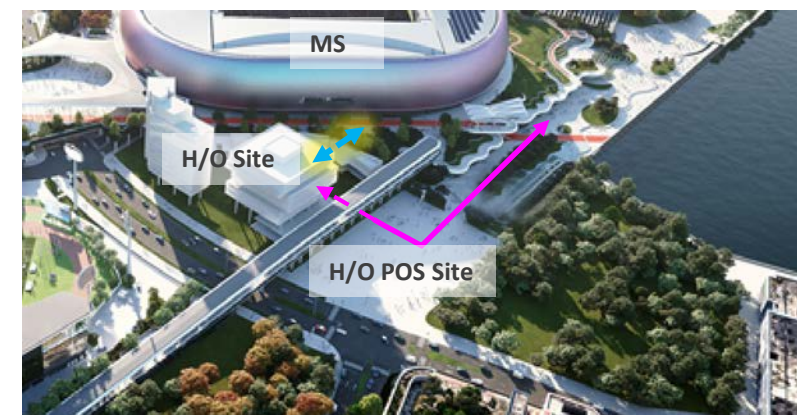
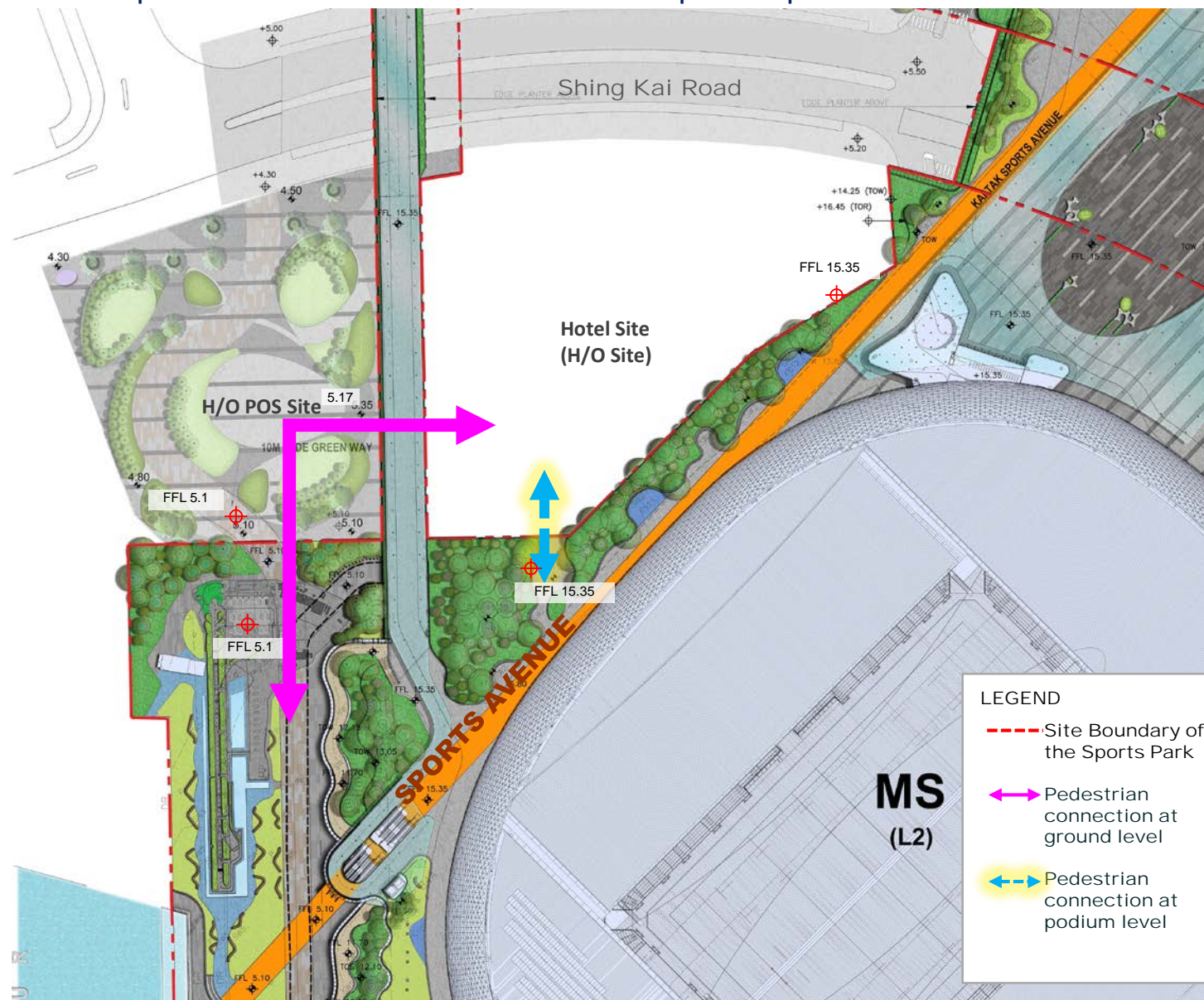

Sports Avenue

- Connecting the heart of the Kai Tak neighbourhood to harbourfront promenade

KAI TAK
SPORTS PARK
啟德體育園

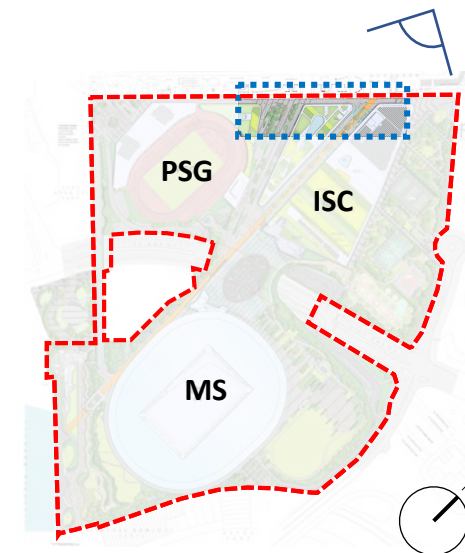
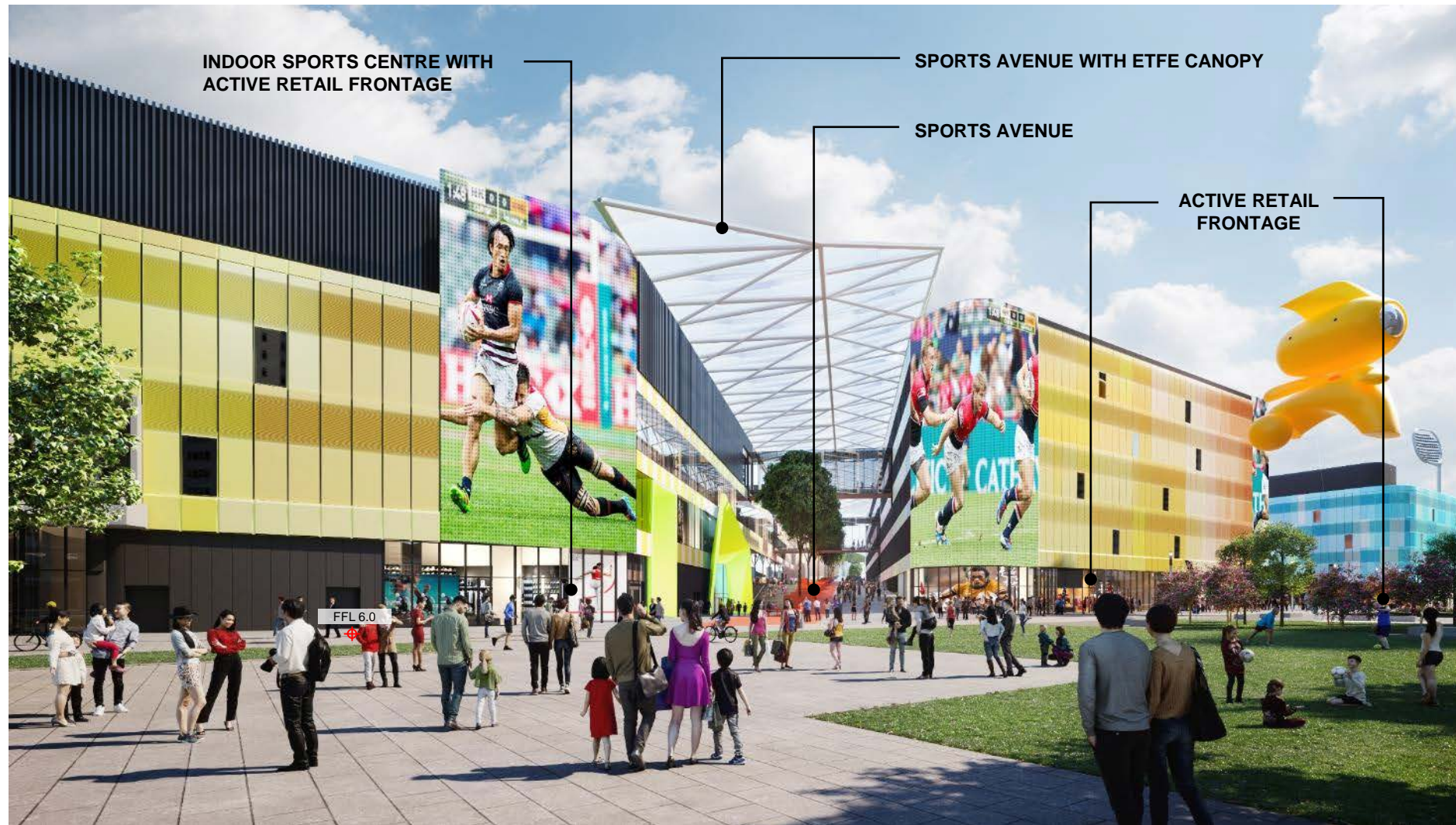

Main Plaza

- Active and vibrant public realm for the various events and/or family outing



MAIN PLAZA CANOPY (8m HIGH)

MAIN STADIUM

MULTI-FUNCTION AREA FOR VARIOUS EVENTS

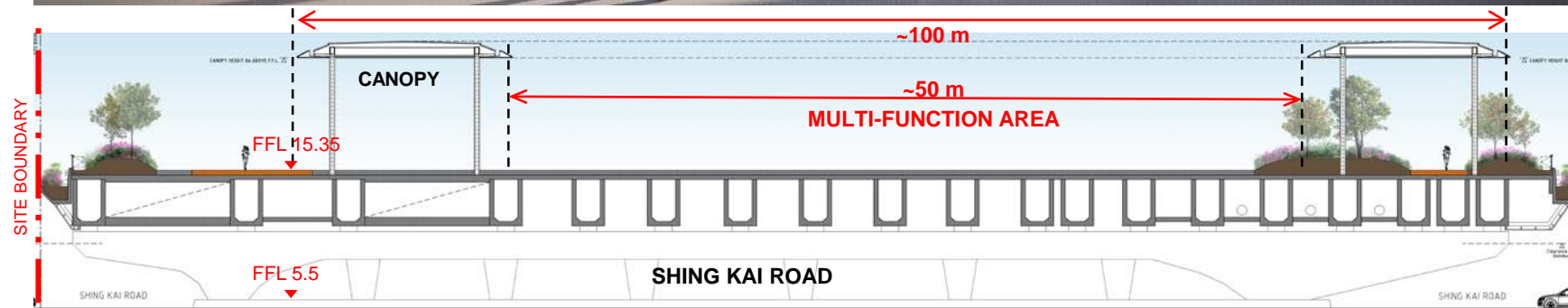
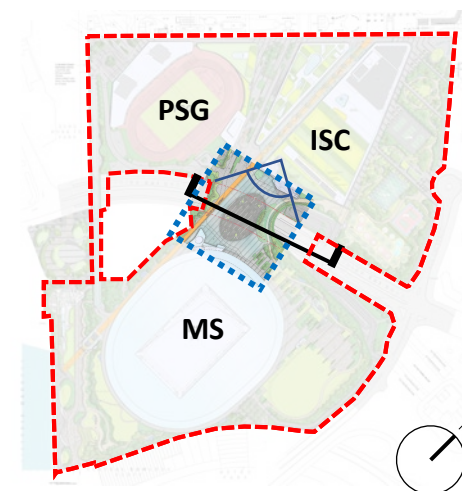

Harbourfront promenade

- Place making for creating unique experiences and moments

KAITAK
SPORTS PARK
啟德體育園



Fence-Free Seat Wall and Harbour Steps

- As a natural setting to visually connect with the harbourfront promenade

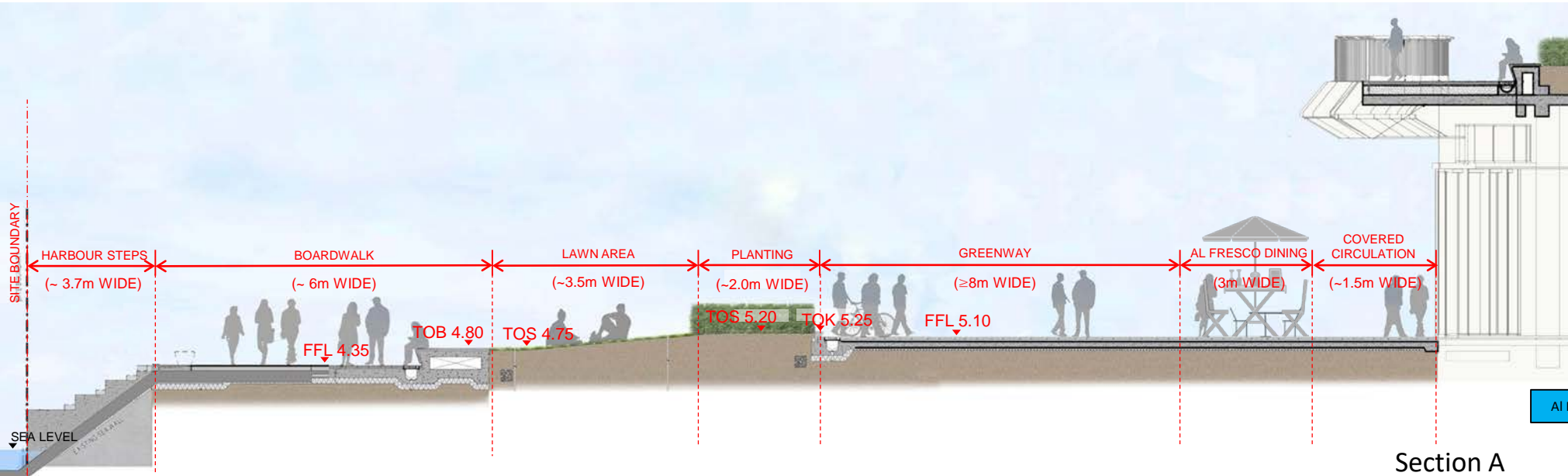

Section A

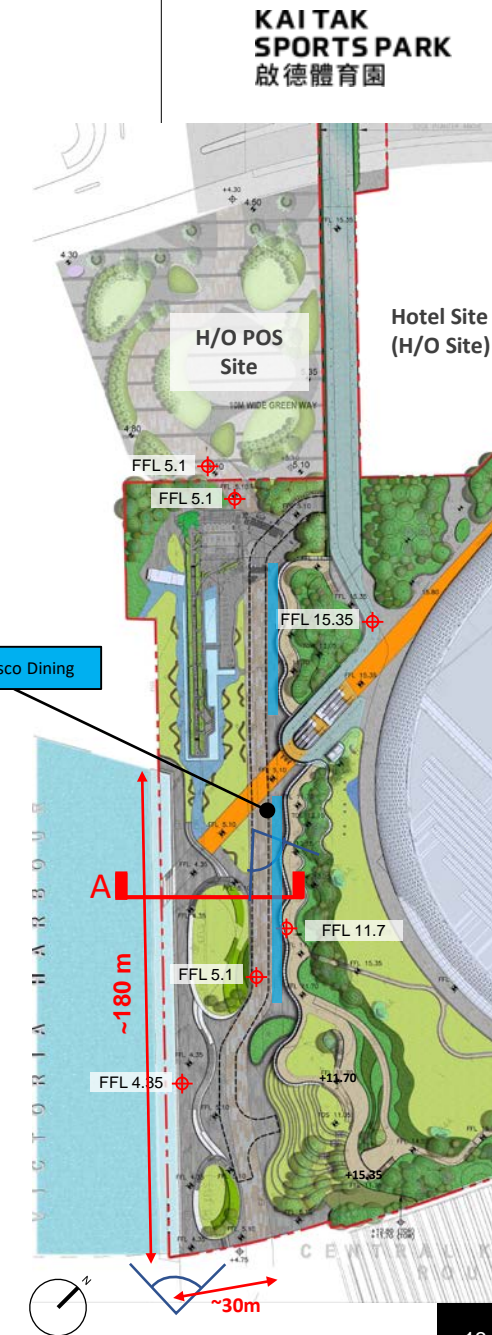
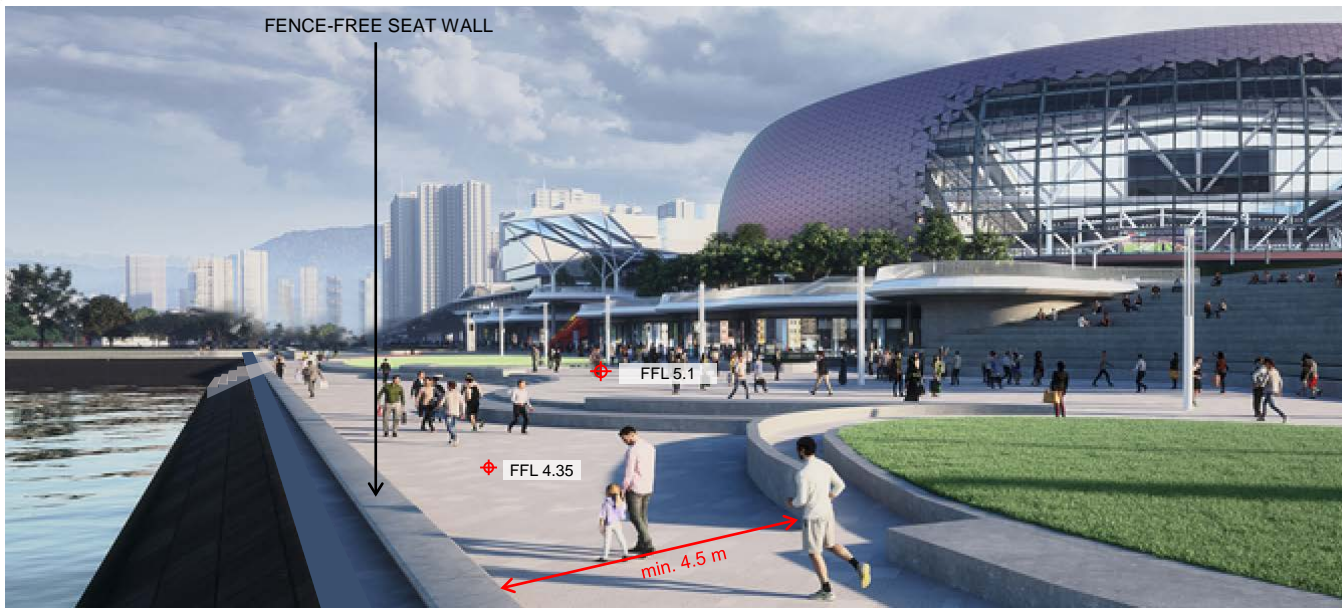

Harbour Steps

- Continuation of Sports Avenue and connection to the harbour

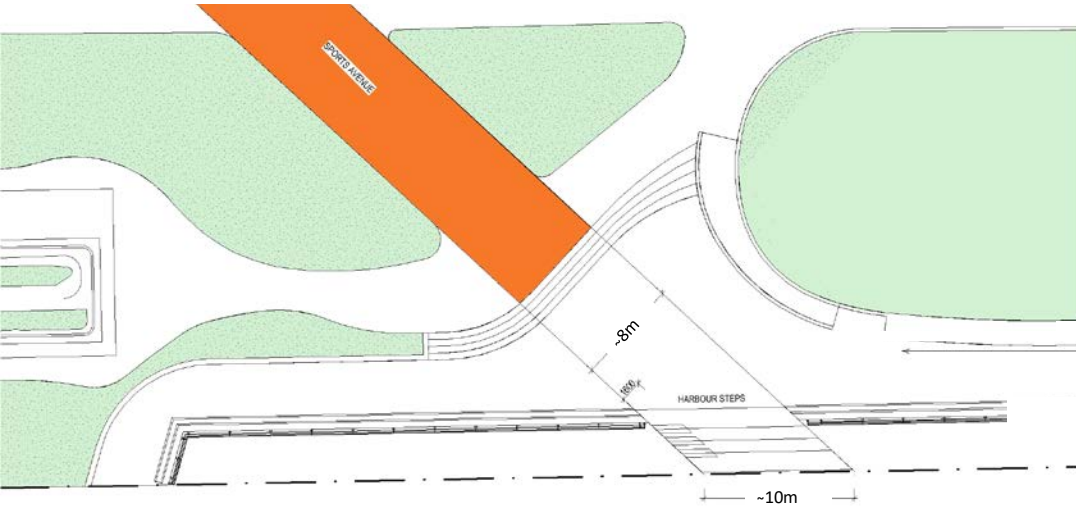

Plan View

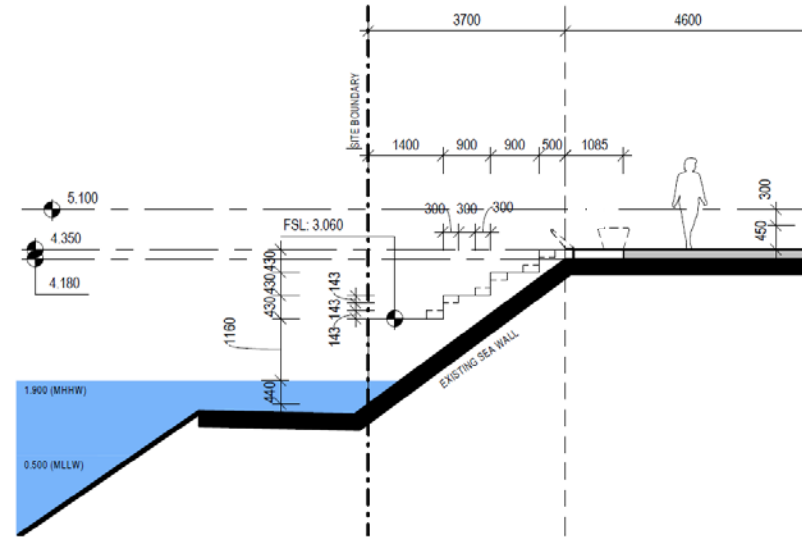

Section A

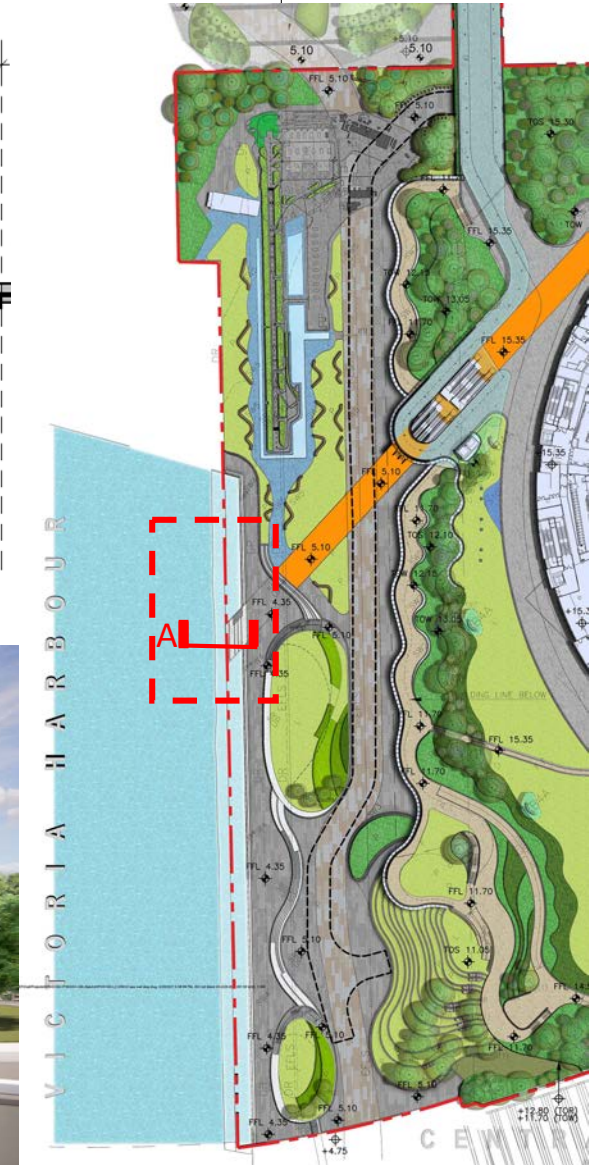

Harbourfront promenade - sheltered provision



View 1



View 2

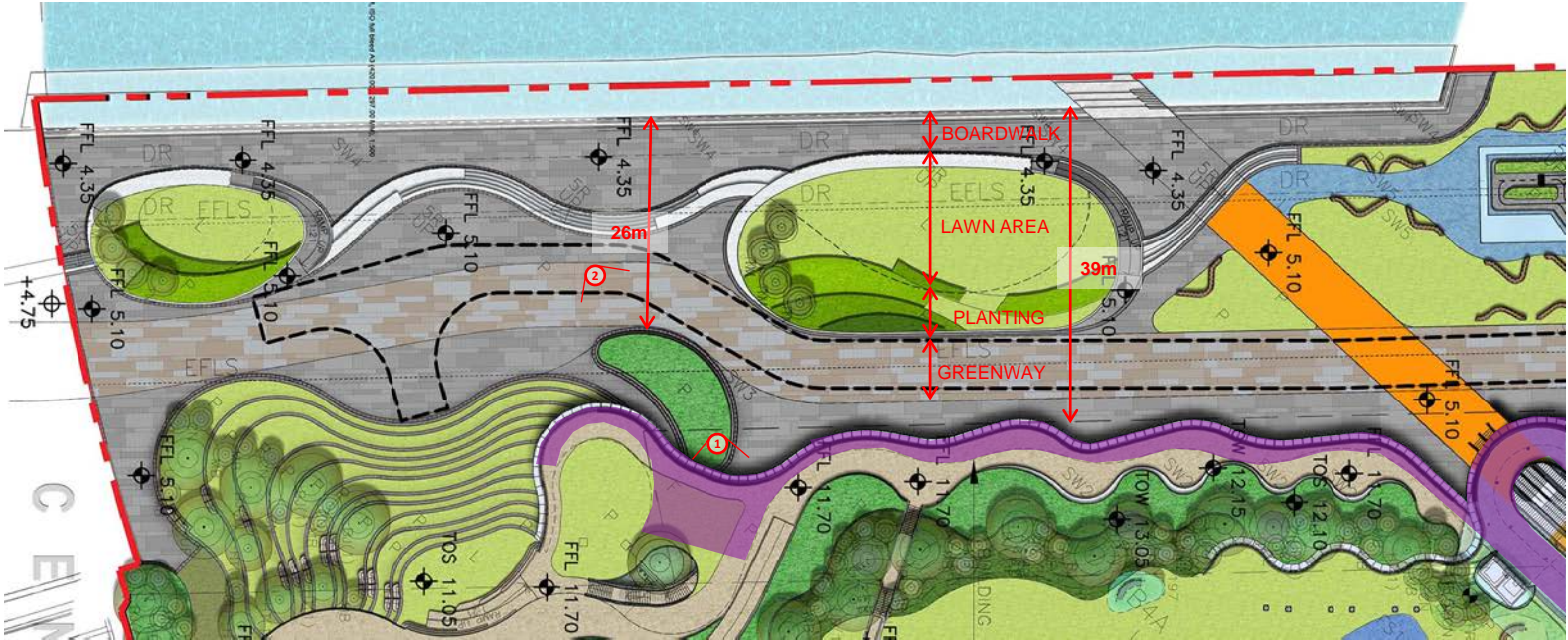

- Legend:
- view
 - sheltered circulation



Harbourfront promenade – tree shading



View 1



View 2

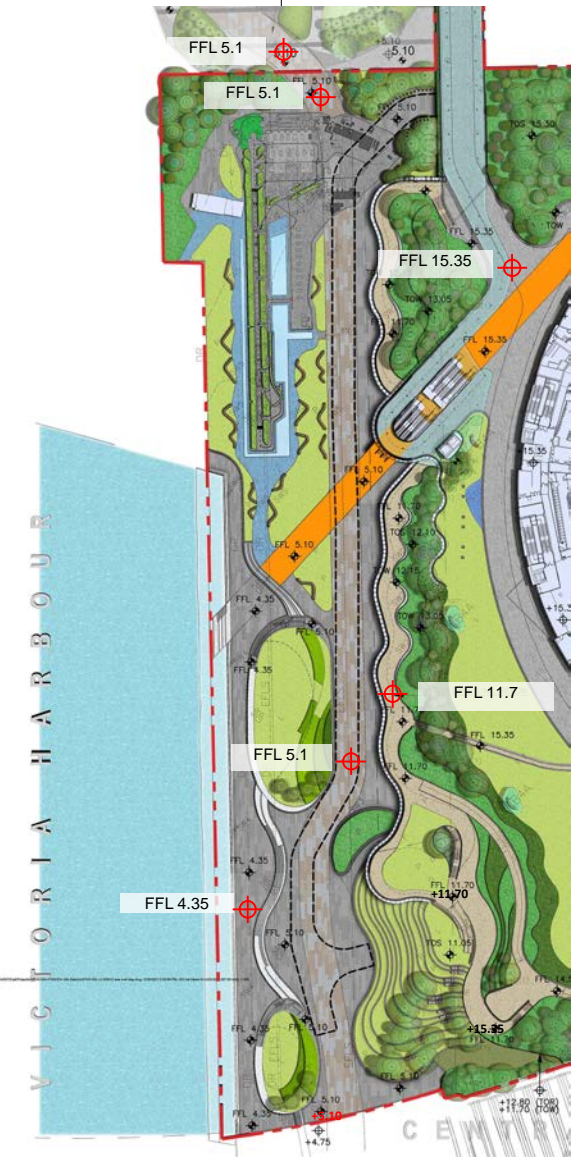
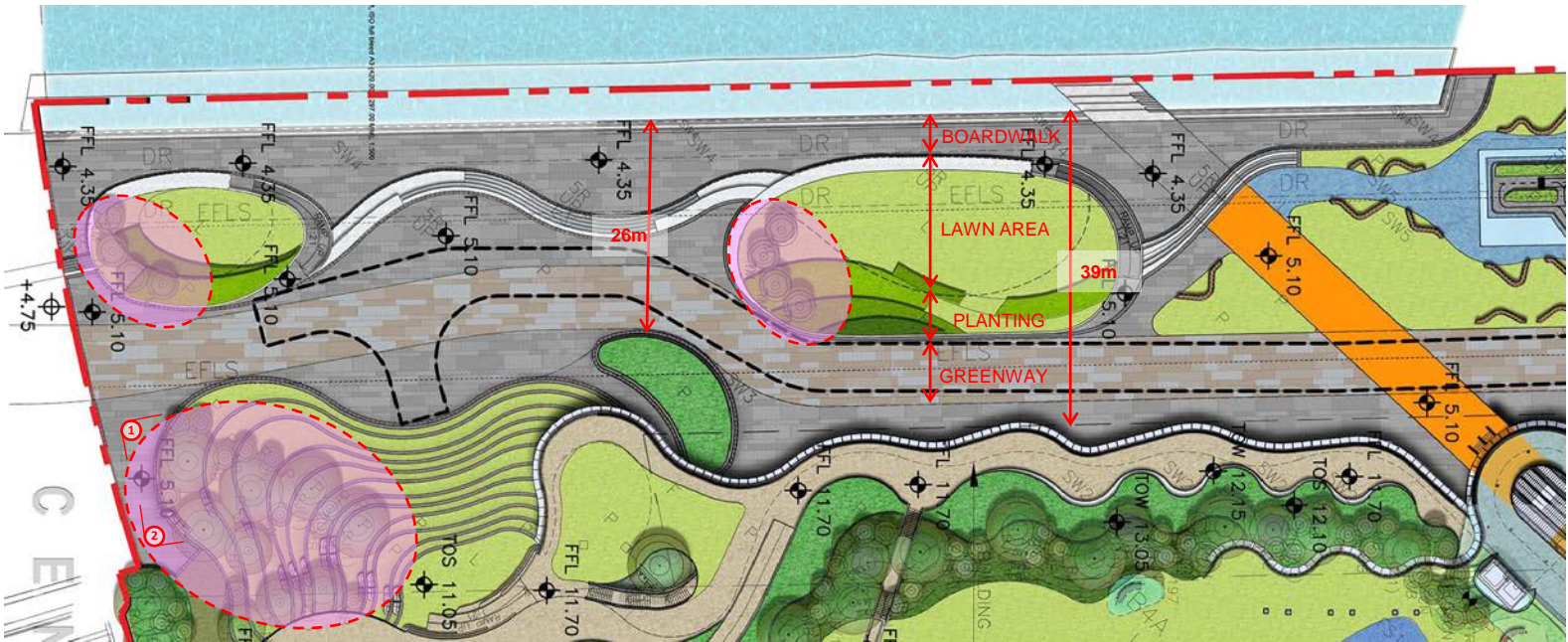

Harbourfront promenade - potential temporary events



Island East Market



Discovery Bay Market

- Legend:
- Potential food truck
 - Potential marquee
 - Toilet and Babycare room

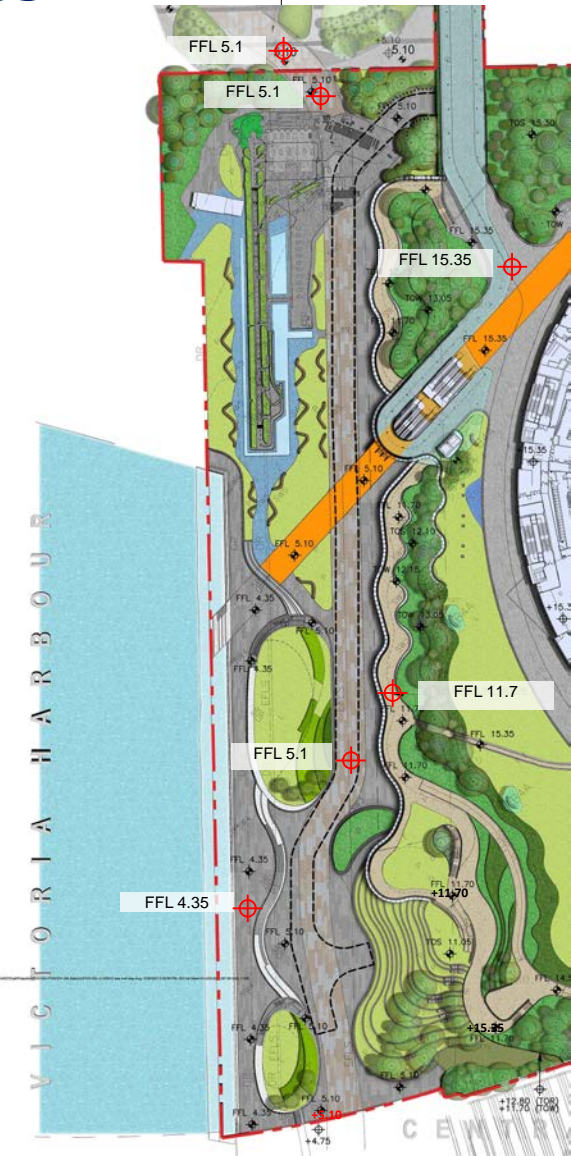
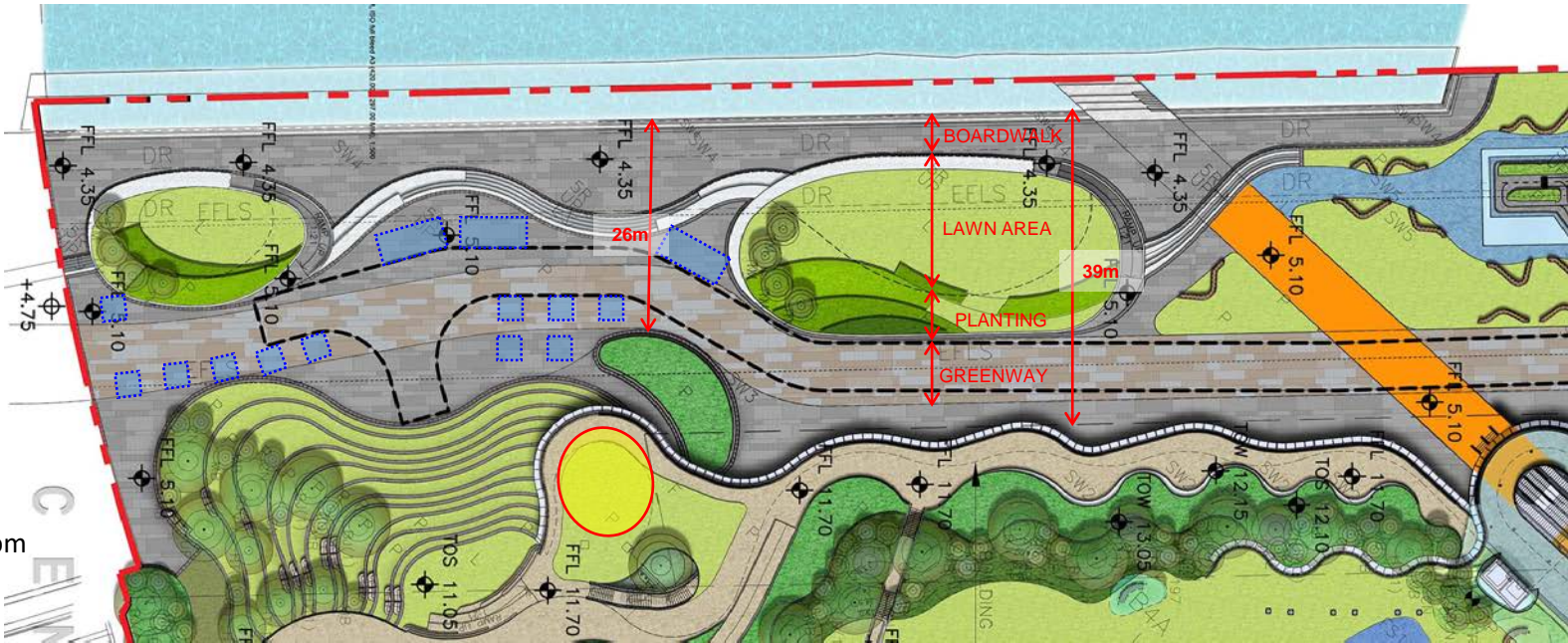

Master Landscape Plan



MAIN PLAZA



HARBOURFRONT PROMENADE



SOUTHERN TERRACE

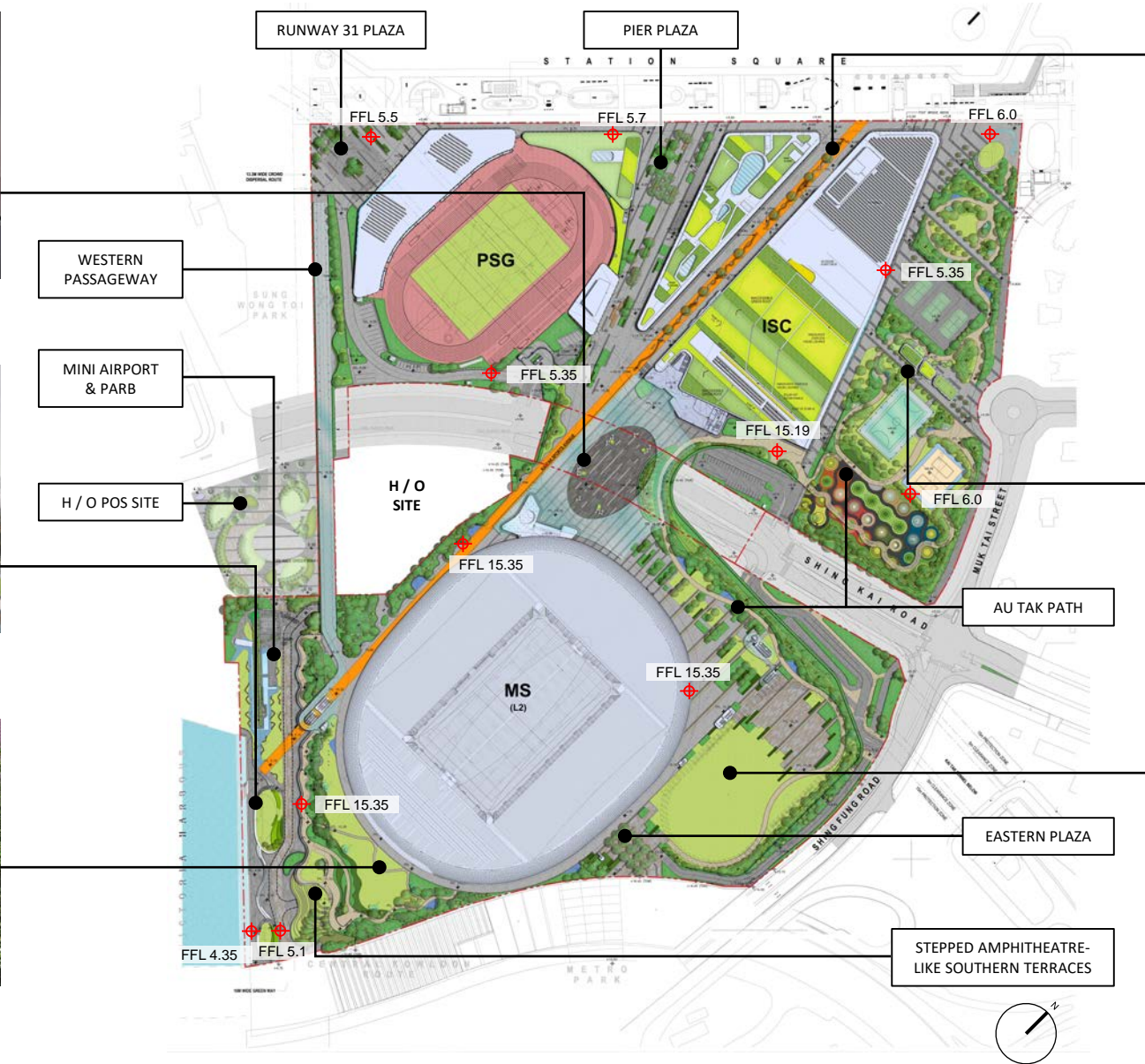

SPORTS AVENUE



NEIGHBOURHOOD PARK



EVENT VILLAGE

Neighbourhood Park

- Attracting people to the park with interesting pathways, children's play area and sports courts

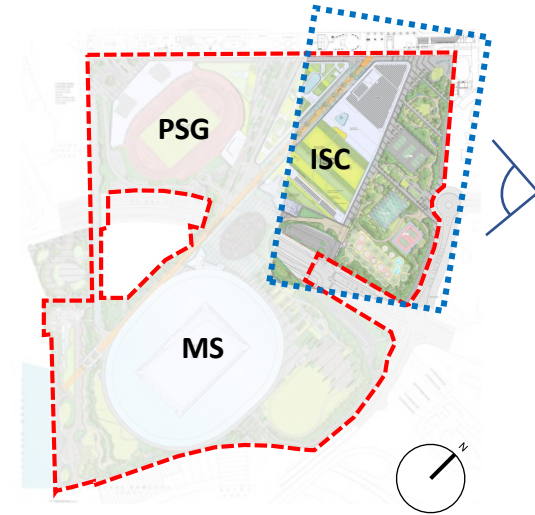

Event Village

- Adjoining turf area for support of major events and/or open green asset for the community



Adjacent Hotel Site Public Open Space (H/O POS Site)

- Adjoining harbourfront promenade of the Sports Park to provide a dynamic & energetic place for public enjoyment

KAITAK
SPORTS PARK
啟德體育園

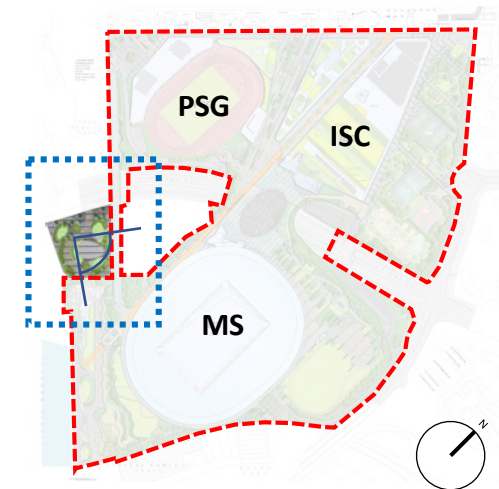
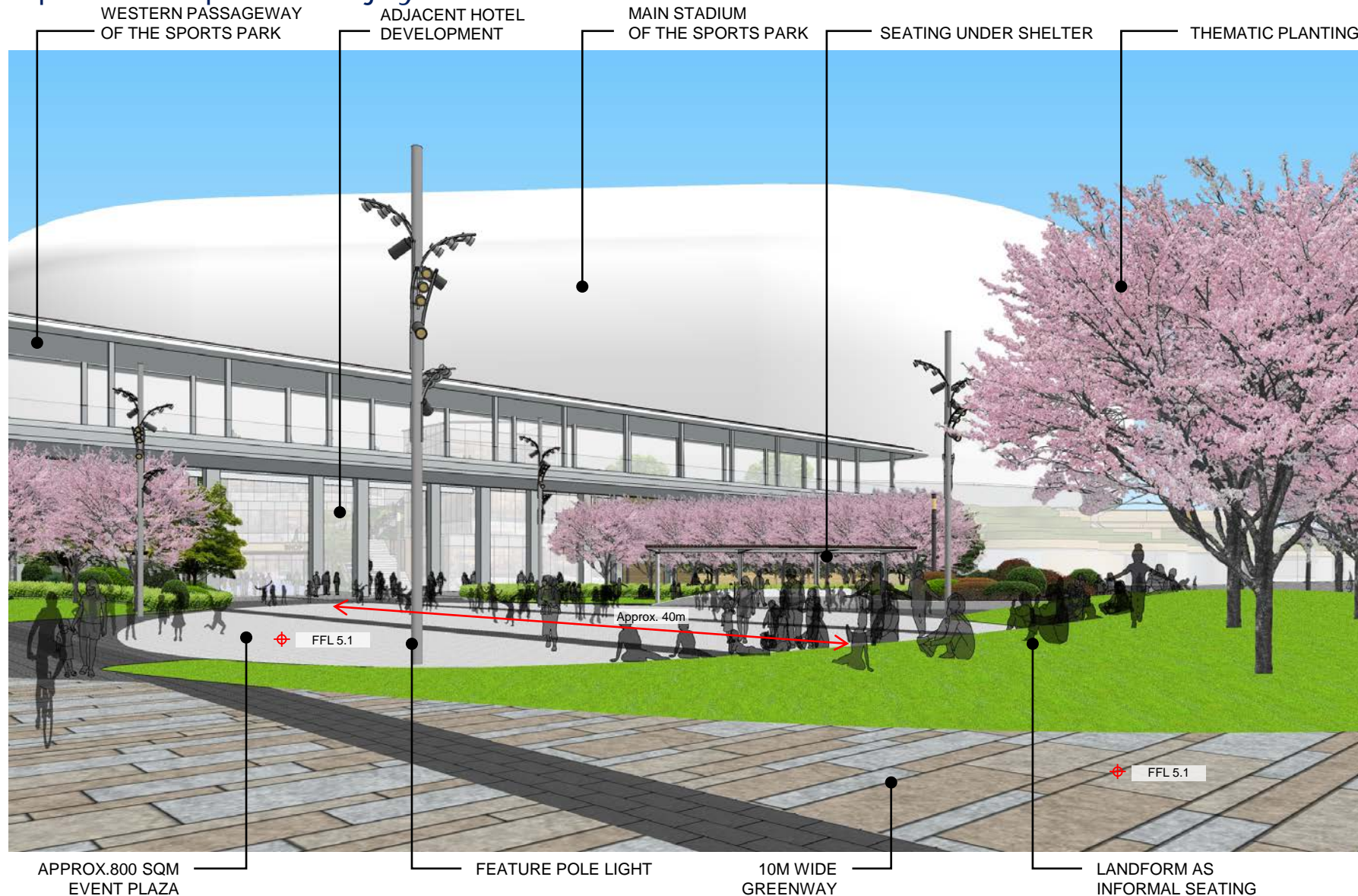

Landscape Concept: "Green Spine" & "Connectivity"

Character - Field, Delta & Coast

- Seasonal flowering Tree and Shrub" will be widely planted at the landscaped zones to display different characteristics with colour and texture.

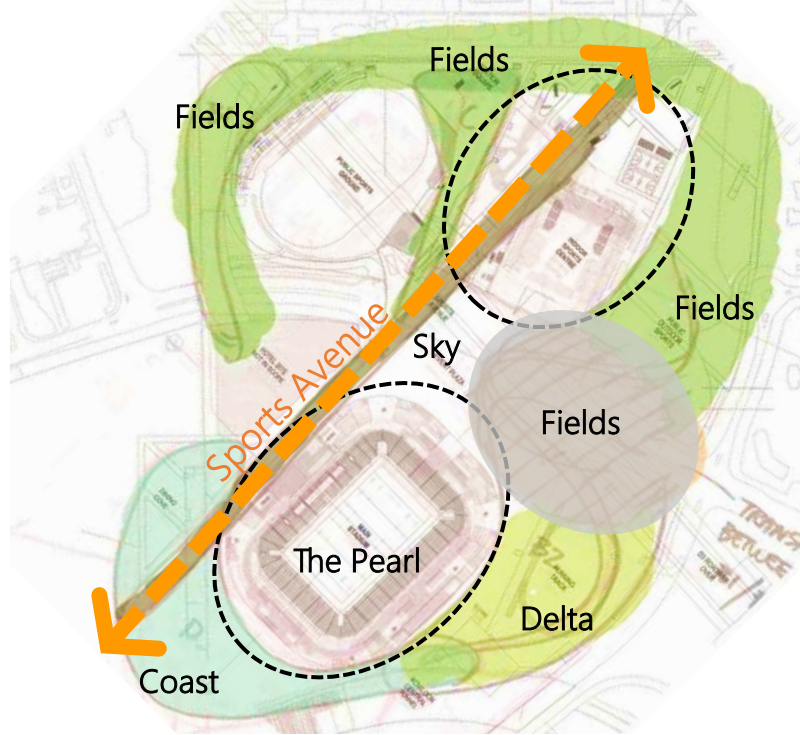

Green Spine & Connectivity

- Sport Avenue to emphasize the "Axis of Connectivity" to all sport zones as "Green Spine" of planting design
- Strong Links between the hinterland and the harbourfront promenade



←-- Sports Avenue

"Eternity Green" - *Bischofia javanica* 秋楓



←-- Pier Plaza Walk

"Eternity Green" *Ulmus parvifoli* 榆樹



←-- East/West Connections

"Boulevard" *Terminalia mantaly* 小葉欖仁



Planting Design

- *Seasonal vibrancy* activated with colour, scent and textures throughout the year.
- *Extensive planting* integrated across multiples levels throughout the site.
- *Biodiversity* variety of species including native and adapted trees, shrubs and groundcover.
- *Urban Ecology* buffer zones with mounding, layered planting and food sources for birds, pollinating species and urban wildlife.

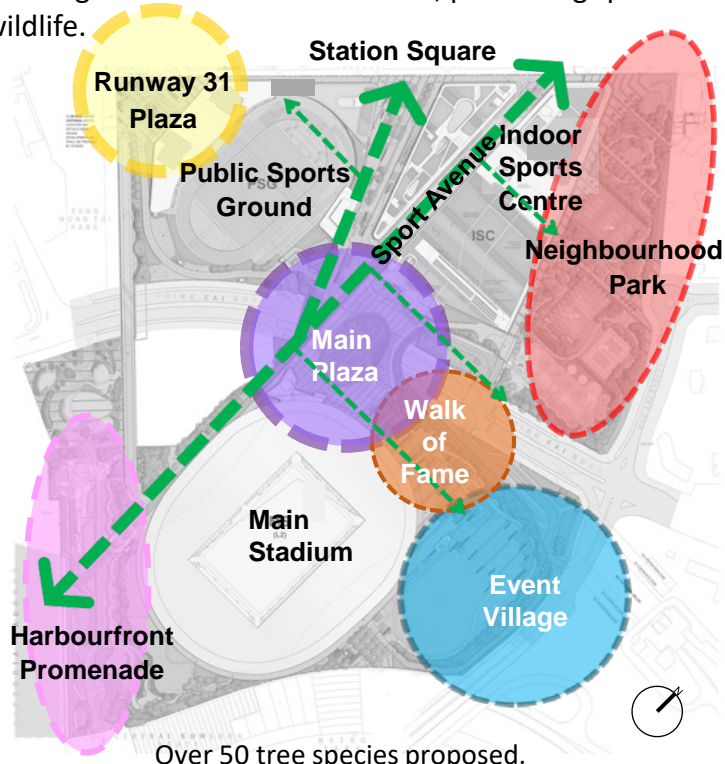

Peltophorum tonkinense
銀珠

“Yellow Harvesting Field”



Cerasus speciosa
大島櫻

Prunus yunnanensis "Guangzhou"
廣州櫻

Cerasus campanulata
鐘花櫻桃

“Seasonal Flowering”



Magnolia gandiflora
荷花玉蘭

Camellia japonica
山茶花

Osmanthus fragrans
桂花

“Refreshing and Fragrant”



(Spring)

(Summer)

(Autumn)

(Winter)

Liquidambar formosana
楓香

“Entrance Precinct of Main Stadium as Colour Medal Focal Point”



Chorisia speciosa St. Hil.
美人樹

“Open and Breathtaking”



Jacaranda mimosifolia
藍花楹

Iris tectorum Maxim
藍蝴蝶

“Blue Blossoming”

Green and Sustainable Features

Green Walls



Image for reference only



Image from www.canevaflor.cl

Fitness Station & Energy Generator



Image from www.tgoc.com

Bio-retention System

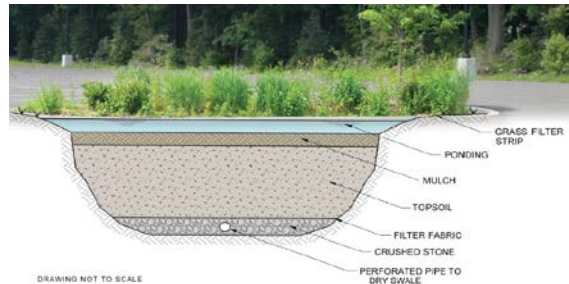
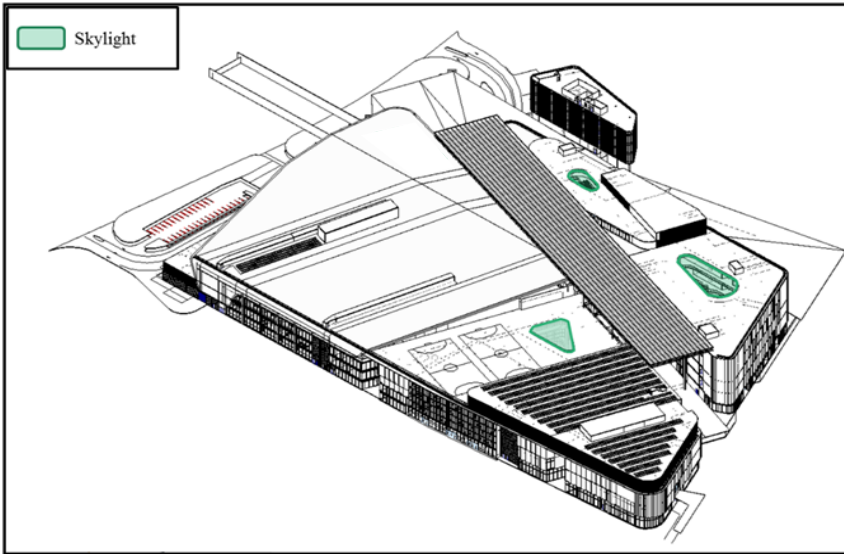
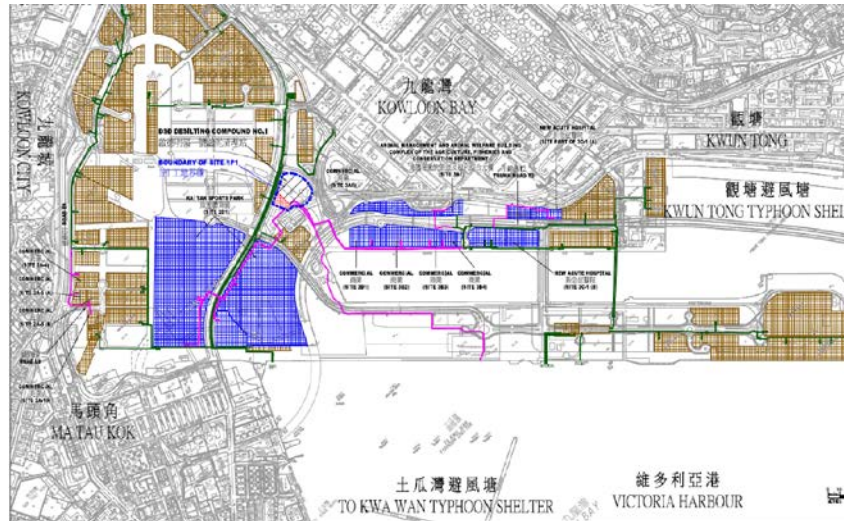

Image from www.lyngsogarden.com

Natural Lighting - Skylights



District Cooling System (DCS)



https://www.emsd.gov.hk/en/energy_efficiency/district_cooling_system_at_kai_tak_development/

Natural Cross Ventilation

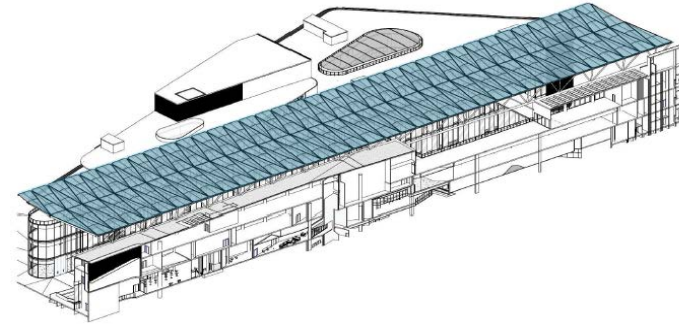

Roof PV Panels



Wind Catchers



Supplier: Monodraught – X-Air Thermal Mixing Unit

KAI TAK SPORTS PARK 啟德體育園

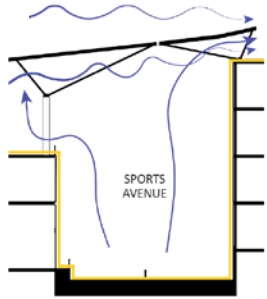

Natural Lighting - Light Tubes



Supplier: SolarTube - Solar Master 330

Other Features include:

- Air Induction Units (AIU)
- Outdoor PV Shelter Seating
- Rainwater Harvesting System
- City Air Purification System

Wayfinding Signage and Public Creatives

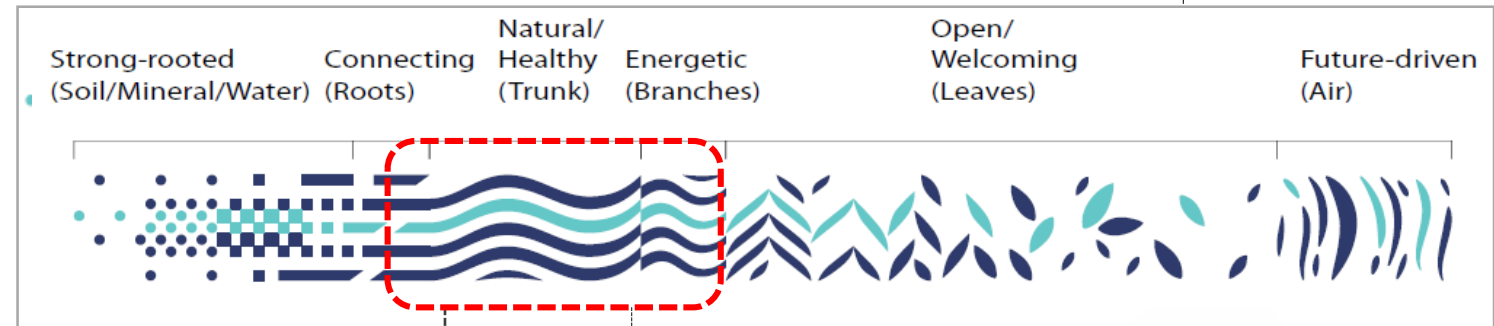

Sports Avenue feature wall

Planting design along promenade

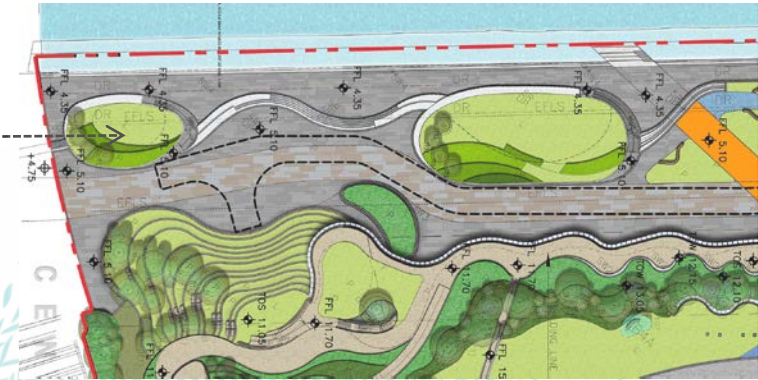

Wayfinding Signage

Special features:

- Interactive/ Digital Screen
- Crowd Control
- Weather Forecast



Adoption of CEDD Kai Tak Brand Identity Manual and Public Creative Guidelines in the Sports Park

Potential design features:

- Promenade and Planting design
- Sports Avenue feature wall

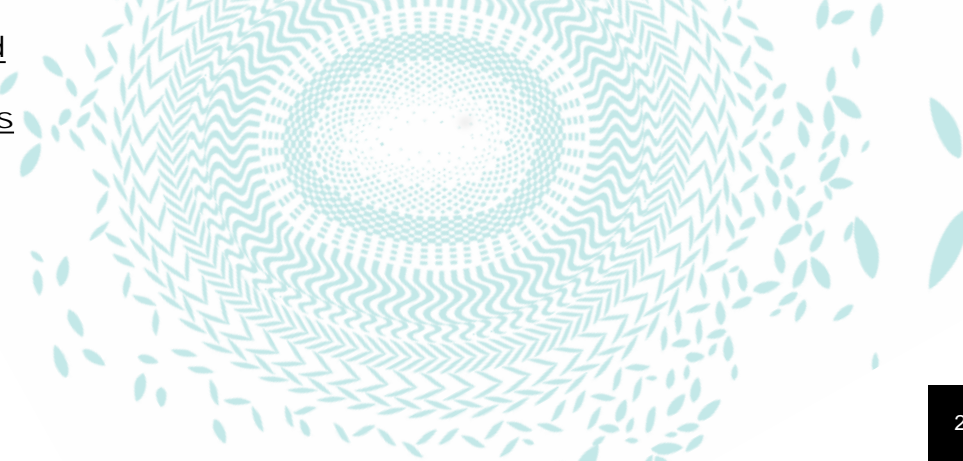

GreenWay Provisions

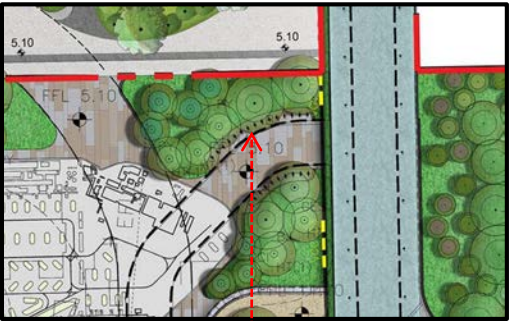

Blow up plan
(50 nos. cycle parking at harbourfront promenade)

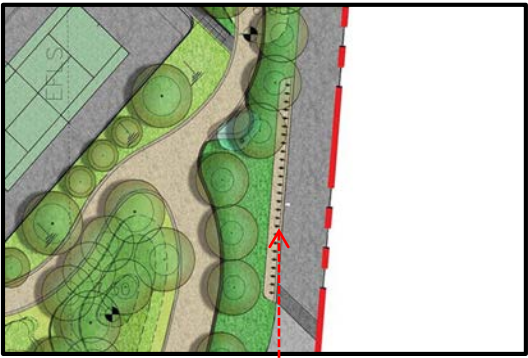
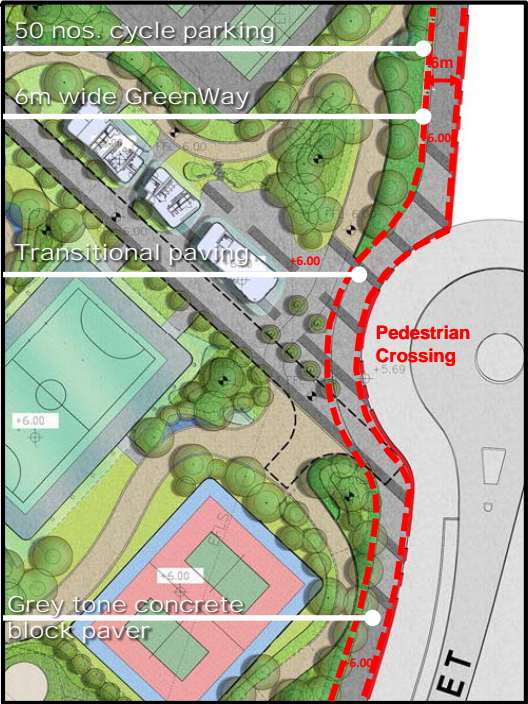
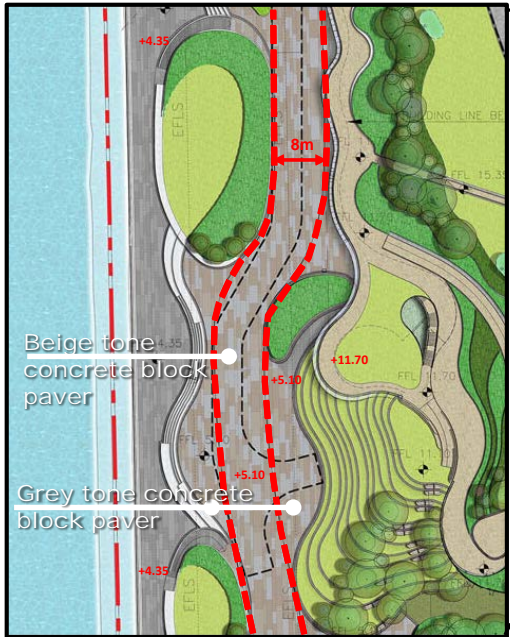

Source: Issue 33 of KAI TAK On the Move 08/2018 by CEDD

Blow up plan
(50 nos. cycle parking at Neighbourhood Park)

Video

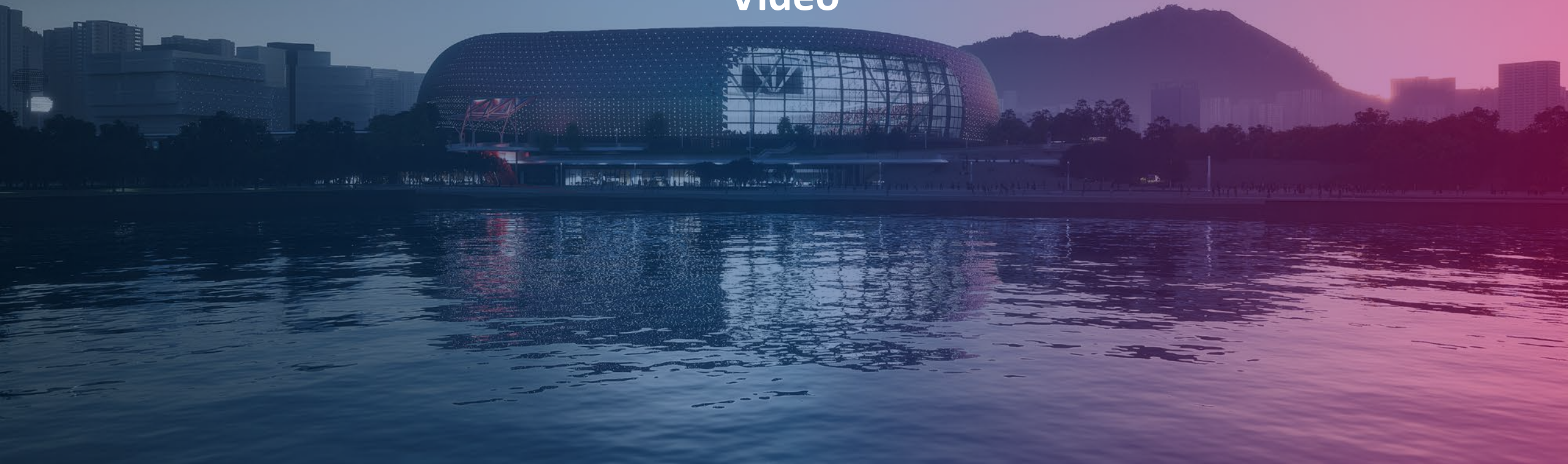

Thank you

